

DU Learning Guide

What is a Browser? (IE7)

"It's my window on the web."

To explore the World Wide Web you use a **Web Browser**.

The most widely used browser is **Internet Explorer**. There are two versions of this: Internet Explorer 6, which you will find on older computers, and Internet Explorer 7, which was made available during 2006. Another browser that is gaining popularity is called **Firefox**.

They look quite different, and Internet Explorer 7 and Firefox have extra features, but they do the same job.

This guide is for Internet Explorer 7.

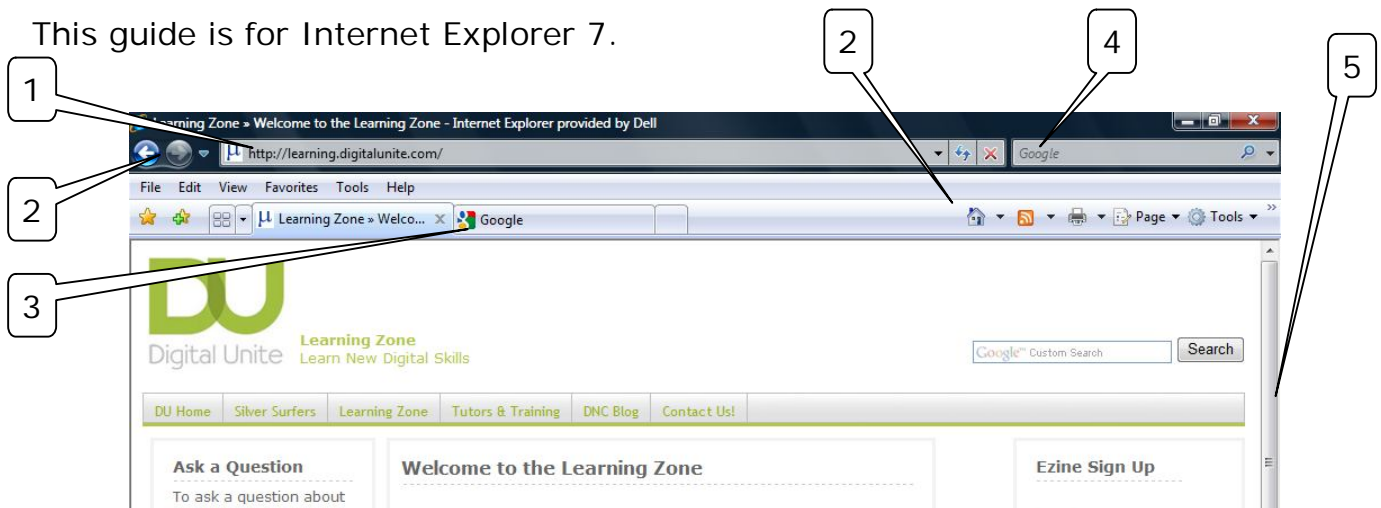

Key parts of the browser are:

1. The Address Bar shows the web address (URL or Uniform Resource Locator) of the page that is displayed in the browser window.
If you know the URL for a web page, you can type it into the address bar and press the **Enter** key to display that page.
2. Tools buttons are in several places. (See next page for more details.)
3. IE7 allows you to have several web pages open in different Tabs.
4. You can type words in the Search Box and search the web. The **Search Engine** selected here is **Google**, but you can change it if you want to.
5. Use the Scroll Bar (or Up and Down arrow keys on keyboard) to move the page up or down.

(Note that moving the scroll bar down appears to make the web page move up. Do it slowly at first.)

The Toolbar Buttons

The tools for Internet Explorer 7 are located in two groups.

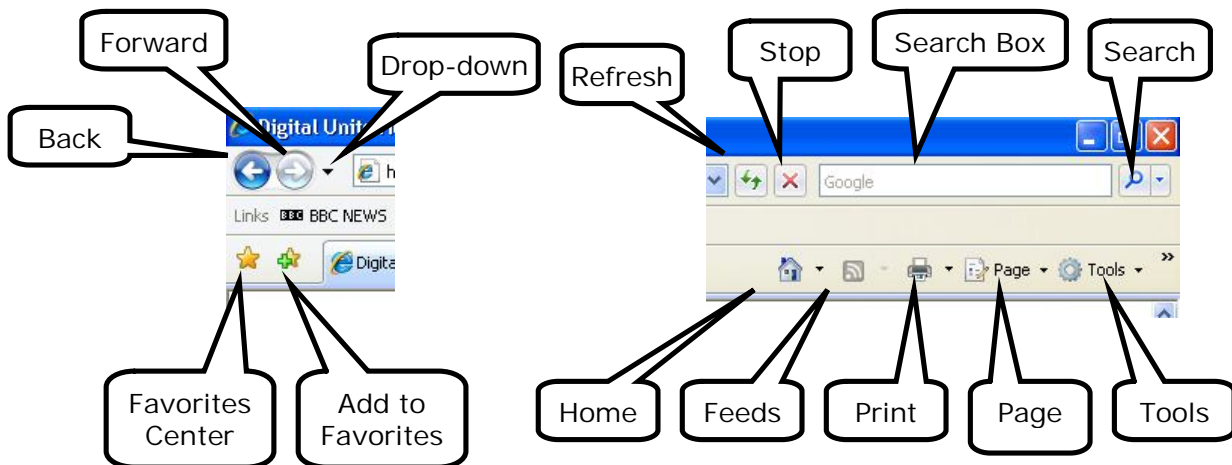

- Use the Back and Forward buttons to move between pages that you have previously displayed.
- The Drop-down arrow displays a list of the pages that you have viewed recently.
- The Favorites Center button displays a panel with links to all the Web Pages that you have stored for quick access. (Favorites Center is spelled like this because Internet Explorer is American!)
- Use the Add to Favorites button to add a web page to your favorites. See **Learning Guide: Favorites and Links** for further details.
- Use the Refresh button to make sure the latest version of a web page is displayed or if a page has not displayed properly
- If a page is taking too long to appear, use the Stop button.
- Click once in the Search Box and type words that describe what you are searching for, then click the Search button, or press Enter.
- In IE7 you can choose the search engine to use. Click on the drop-down next to the Search button to change search options.
- The Home button takes you to your Home Page. Click on the drop-down next to the Home button to change your home page. IE7 allows you to have several home pages on different tabs if you wish.
- Feeds are used for updating web pages as you view them. They are often used by news websites.
- The Print button prints the page you are viewing. The drop-down allows you to preview the print version or change the print set-up.
- The drop-downs next to the Page and Tools icons allow you to use more advanced IE7 functions.
- To increase text size on the page that you are viewing, click on the Change Zoom Level button at the bottom right of the browser window. For other zoom options, click on the drop-down arrow.

